

**BEFORE PRINTING TURN OFF ANY SIZE ADJUST SETTING ON YOUR PRINTER,
VERIFY PRINTED HOLE SIZES BEFORE DRILLING**

DLA DRILL TEMPLATE

Cut and tape this template on your chassis to use a guide.
Re space the connectors and PCB as desired.

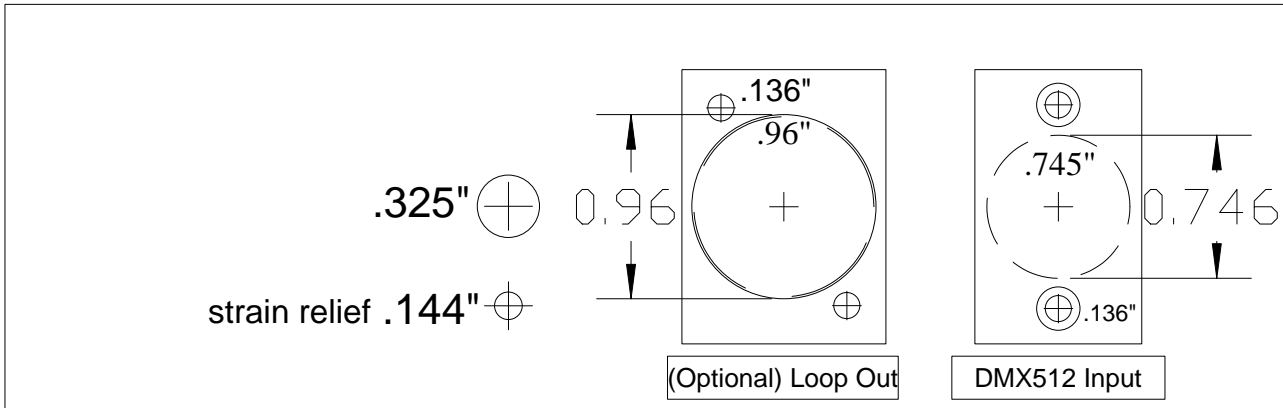
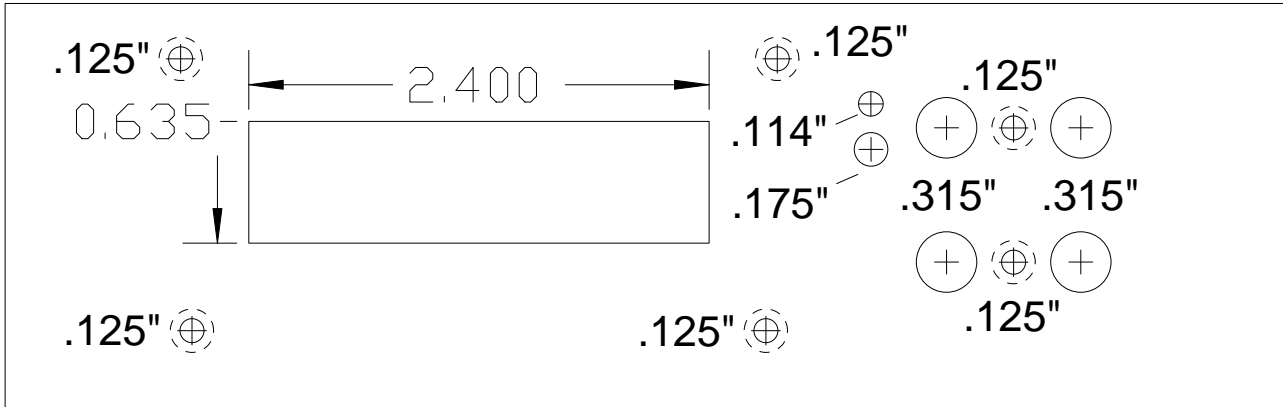

Dimensions for Switchcraft D3F, D5F, D3M, D5M 3 or 5 Pin Chassis mount XLR's

Any 3 or 5 pin XLR connector can be used; chassis mount or inline.

Handle the PCB with static electricity precautions - touch a grounded source to discharge static electricity before touching the PCB

WIRING DIAGRAM Top View

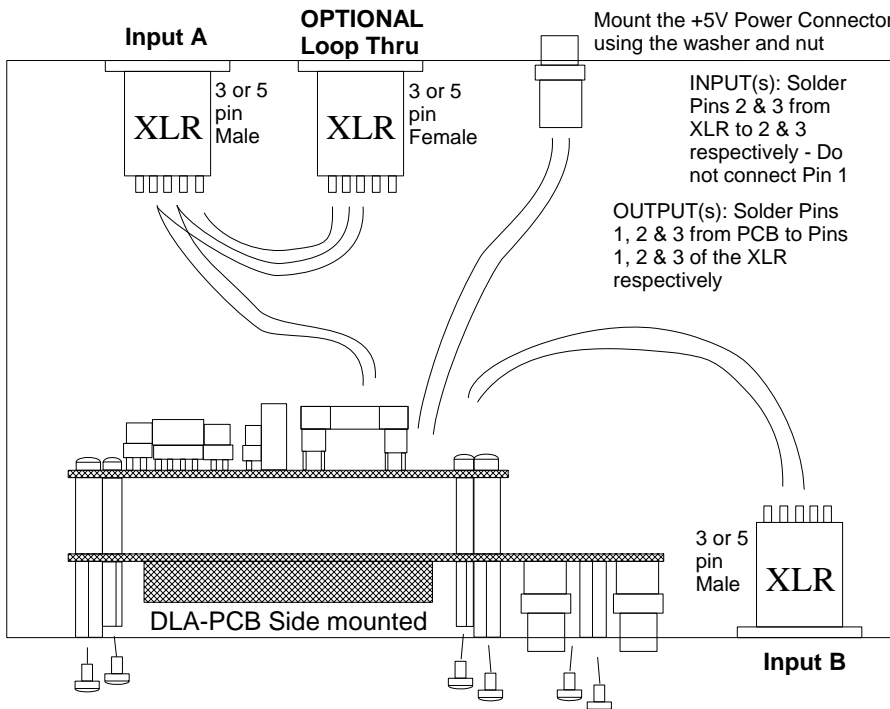

INPUT(s): Solder Pins 2 & 3 from XLR to 2 & 3 respectively - Do not connect Pin 1

OUTPUT(s): Solder Pins 1, 2 & 3 from PCB to Pins 1, 2 & 3 of the XLR respectively

Mount XLR connector as desired. Recommended wire: 24 AWG stranded & twisted together. Connect pins 2 and 3 only from the XLR input connector to the PCB labeled "In A" and "In B" pins 2 & 3.

Take care AND inspect that the wires do NOT short. Check for stray wires that could short.

IMPORTANT NOTE - TERMINATE ALL NON LOOP THRU CONNECTORS BY SOLDERING A 120 OHM RESISTOR BETWEEN PINS 2 AND 3. TERMINATE ALL UNUSED LOOP THRU CONNECTORS.

OPTIONAL front mount XLR, make the B input (LED will light when 'B' is selected)